

Raingarden Edge Treatment Materials C120.06



BATTERED EDGE TREATMENT



CONCRETE EDGE TREATMENT



TIMBER RETAINING WALL TREATMENT

DESIGN STATEMENT

Water Sensitive Urban Design (WSUD) is an approach to improve sustainable use of water in the urban environment.

Raingarden edge treatments may vary depending on design requirements. Below are three recommended options:

Battered edge treatment: Battered edge from top of back of kerb, batter may start below a 190mm drop. Batter gradients should be considered with reference to the available space for the raingarden and safety for inadvertent pedestrian access and maintenance activities

Concrete edge: Concrete edging is made from cast in situ concrete wall typically 150mm thick.

Timber retaining wall: Timber retaining wall generally constructed from hardwood timber or treated pine sleepers.

Moreland City Council Streetscape WSUD Raingarden and Tree Pit Design Package (WSUD Package) provides a suite of design elements, applications and standard drawings to assist WSUD site-specific design.

APPLICABLE LOCATION

As specified.

COUNCIL STANDARD DRAWING

N/A

CROSS REFERENCE DOCUMENT

- Moreland WSUD Design Package

STANDARD SPECIFICATION

Refer to WSUD Package, Section 4. Autocad Library:

- Raingarden Edge Treatment Materials - Drawing SK006

SUPPLIER

Refer to WSUD Package, Section 10. List of Supplier.

MAINTENANCE

Refer to WSUD Package, Section 8. Maintenance Checklist.

GENERAL NOTE

1. The standard details shown on this drawing are typical only. These details may need to be reconfigured to suit site specific conditions.

C120.06 Raingarden Edge Treatment Materials

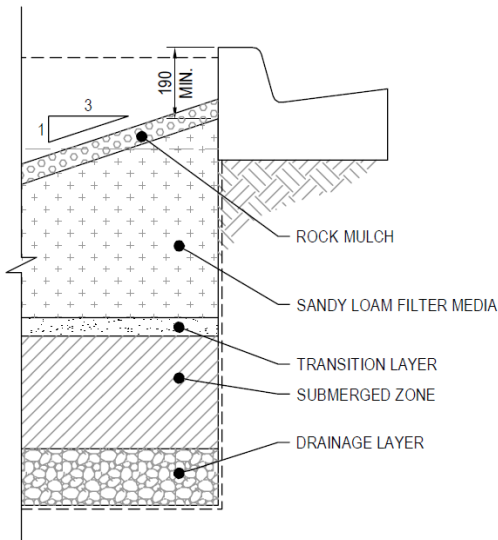

BATTERED EDGE TREATMENT

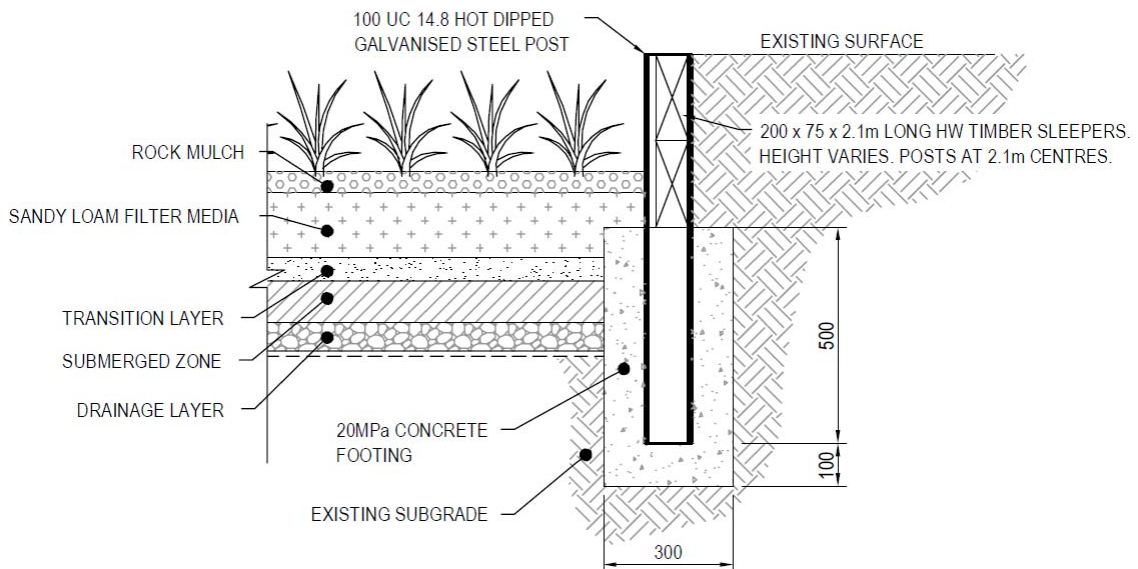

CONCRETE EDGE TREATMENT

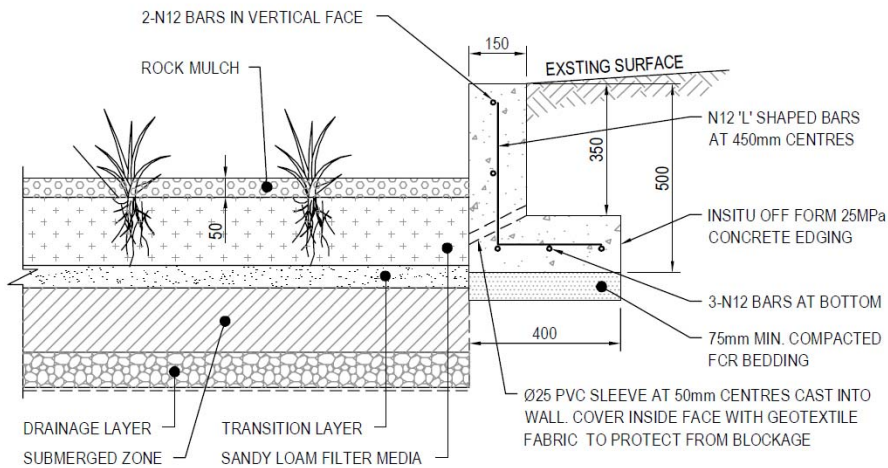

TIMBER RETAINING WALL TREATMENT