Concrete Pavers Footpath A110.09



DESIGN STATEMENT

Precast mid-dark grey concrete pavers are the standard footpath paving treatment used on Pascoe Vale Road between Gladstone Parade and Finchley Avenue, Glenroy.

Precast concrete pavers provide a very durable, neutral, high quality finished paving treatment.

APPLICABLE LOCATION

Glenroy Activity Centre: Pascoe Vale Road between Gladstone Parade and Finchley Avenue.

COUNCIL STANDARD DRAWING

N/A

CROSS REFERENCE DOCUMENT

- Glenroy Activity Centre Streetscape Masterplan

STANDARD SPECIFICATION

Moreland Striped Pattern concrete pavers in charcoal colour. The standard size paving unit is 397 x 397 x 60mm and is laid in a stretcher bond pattern with 6mm spacings. The surface pattern is 25mm sandblasted bands as specified. The paving should be consistent finish, level, and flush with existing pavement surfaces.

SUPPLIER

Urbanstone Pty Ltd or Council approved supplier.

MAINTENANCE

Road Maintenance Unit: Repair failed areas of pavement with similar concrete pavers.

Street Cleansing Unit: Cleaning will be undertaken as per current schedule.

GENERAL NOTES

1. Refer to manufacturer's installation manual

July 2019



Moreland City Council

A110.09 Concrete Pavers Footpath

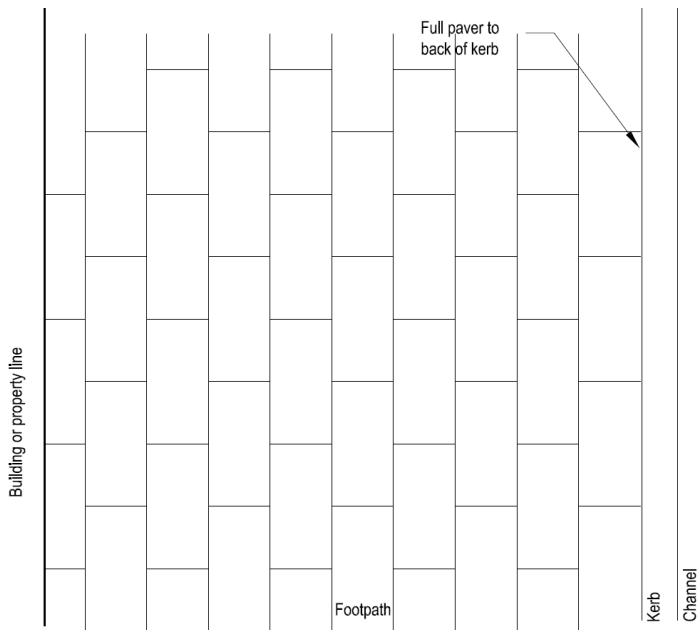

Typical Arrangement

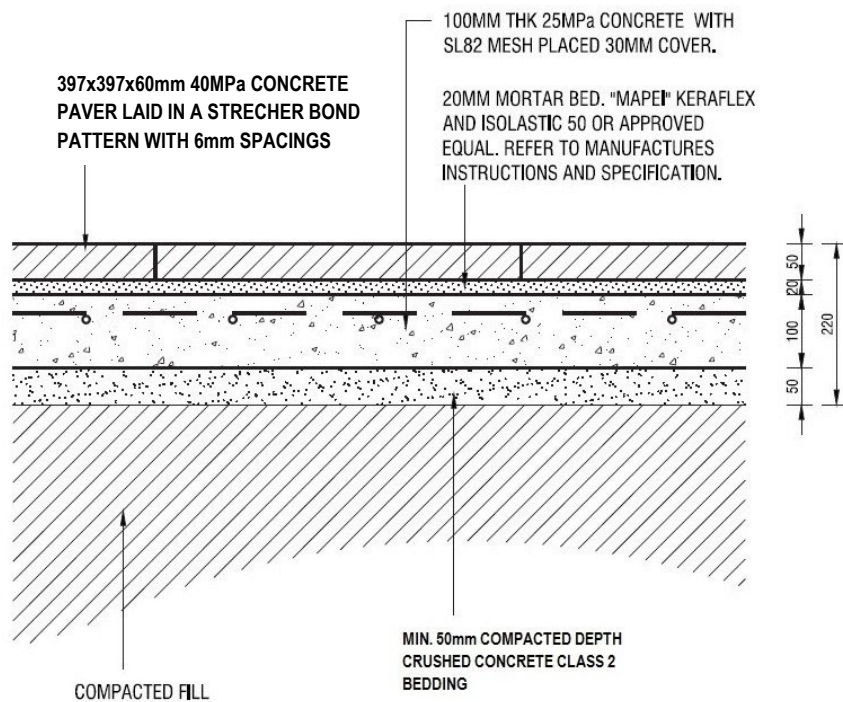

Typical Precast Concrete Paving Detail